

RESIDENTIAL LAND FOR SALE

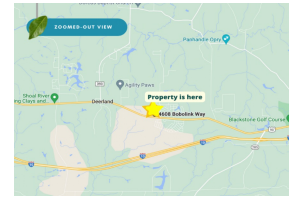
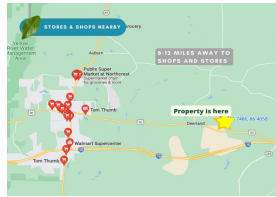
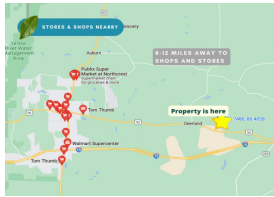

4608 Bobolink Way
Crestview, Florida
United States

Asking Price
\$30,000

Parcel Size **1 Acres**

Date Listed **09/13/2024**

Listing ID **GL-
1694623522**

Listed by: Landcentury

For more information, visit:

<https://www.globallistings.com/10759222>

Overview

Build your dream home on this half-acre homesite in Okaloosa County, Florida. Nestled on Bobolink way, this property is just 7 minutes away from Blackstone Golf Course, Mossy Head School, Emerald Coast Zoo, and many more. Drive up just 14 minutes west and you will reach downtown Crestview. You can explore Twin Hills Park in the heart of the city. There are two ponds with paths around them, gazebos, multiple pavilions with picnic tables, a beach volleyball court, and basketball and tennis courts. The city is also a hub for craft distilleries producing high-quality spirits from locally-sourced Florida grains and fruits. Crestview is the perfect place to come and settle and enjoy retirement. The crime rate is low and the city is very quiet at nighttime. There are wonderful services nearby that are very resourceful for the community's needs. What are you waiting for? Call us now to learn more about this offer! Cash Price: \$30,000 Property Details: Parcel #: 24-3N-22-2460-0012-0110 Property Address: 4608 BOBOLINK WAY, CRESTVIEW, FL, 32539 Subdivision: THE PINES County: Okaloosa County State: Florida Parcel Size: 0.5 acres Legal Description: LOT:11,12 BLK:12 SEC/TWN/RNG/MER:SEC 24 TWN 03N RNG 22W THE PINES S/D LOTS 11 12 BLK 12 MAP REF:MAP 5 Land Use: VACANT RESIDENTIAL Property Type: RESIDENTIAL-VACANT LAND GPS Center Coordinates: 30.745300, -86.407200 GPS Coordinates (Corners): 30.745156, -86.407486 30.745152, -86.406964 30.745515, -86.406961 30.745520, -86.407476 Tax Amount: \$115 Google map link: <https://goo.gl/maps/Rrm3MDgZvDWeCRVT9>

Contact

Email

Phone

sales@landcentury.com

888-526-3932

