

**RESIDENTIAL LAND FOR SALE**

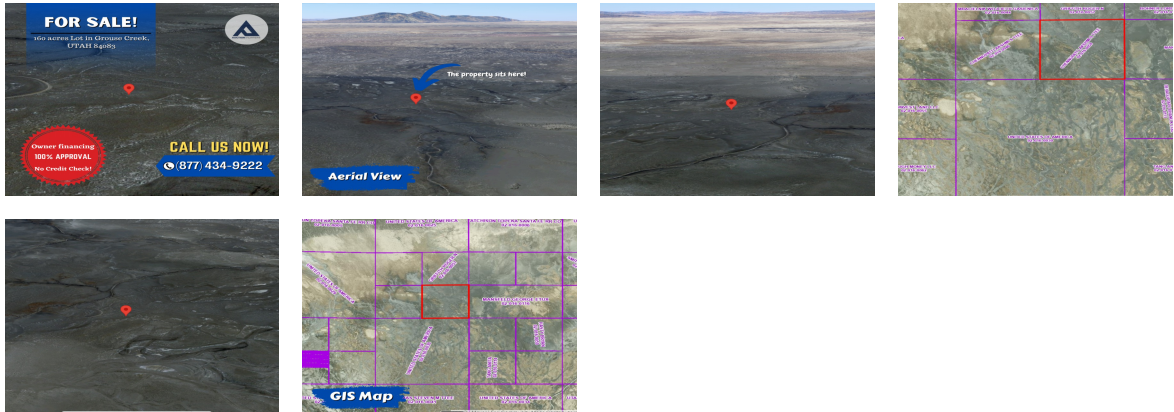

Parcel Size **160 Acres**      Date Listed      **09/13/2023**

**Greenhaven, Utah**

Listing ID      **GL-1694623262**

**United States**

**Asking Price**  
**\$41,995**

Listed by: Landcentury

For more information, visit:

<https://www.globallistings.com/1075911>

**Overview**

Lot size: 160 acres Exact Location of the tract: Just south of State Route 30 in Northwestern Utah. West of the Great Salt Lake. North of Interstate Highway 80, with easy access to IH 80 from State Route 30. Here are the google coordinates for the exact location of 160 acres of land: GPS: 41.41209, -113.46729 Fairly flat, with light scrub brush vegetation Mountain views to the west of the Bovine Mountains and to the north of the Mahogany Peaks. The closest town for satisfying shopping needs is Wendover, Utah on IH 80. Tracts are surrounded on two sides by Bureau of Land Management (BLM) land. BLM land is public-use land, increasing your ability to hunt or hike on 800 acres instead of the 160 acres owned. Zone: MU-160 All taxes were paid. Taxes per year: \$100 (NO BACK TAXES) Grouse Creek, UT 84083 Parcel: 02-016-0058 Property Type: Vacant Land Zoning: Recreational Utilities: Please Contact County Deed Type: Special Warranty Deed Road Access: Fairly flat, with light scrub brush vegetation County: Box Elder GPS: 41.41209, -113.46729 DISCLAIMER: All properties are sold as-is. Any property that is the subject of this sale is sold As-is without any warranties or representations of any kind or character, express or implied, with respect to the property. The owner has not visited the property and is not aware of the overall condition. This property will require rehab, or need to be rebuilt. The owner acquired the property via tax lien foreclosure. This property has been deeply discounted. Buyers are urged to do due diligence on property conditions, back taxes, and liens prior to bidding. All buyers are deemed to have relied entirely on their own information, judgments, and inspections of the assets in making the decision to purchase the asset. All sales are final.

**Contact**

**Email**

**Phone**

[sales@landcentury.com](mailto:sales@landcentury.com)

**888-526-3932**

