

RESIDENTIAL LAND FOR SALE

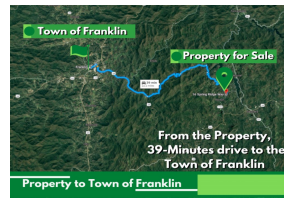
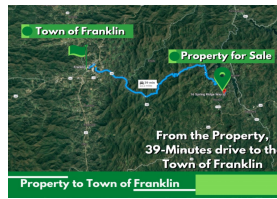
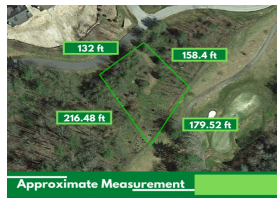

16 Spring Ridge Way
Cullowhee, North Carolina
United States

Parcel Size **1 Acres** Date Listed **09/13/2023**
Listing ID **GL-1694625446**

Asking Price
\$139,500

Listed by: Landcentury

For more information, visit:
<https://www.globallistings.com/10757420>

Overview

~~ Contact Norman Nelson to learn more: 56two-41two-2920 - normannelsoninvestments(at)gmail(do)com
 ~~ This pristine 0.62-Acre gem is perfect for your dream home! It has a flat area for footing a house, easy access by roads, and a view of 15th and 10th holes and mountains. Huddled in the Rolling Hills of breathtaking Jackson County, this lot enjoys the Cool vibe brought by the pleasant surroundings, and let's not forget the Vineyards and Wineries within just a 40-mile radius of the property. This hidden paradise offers a wide-open space and the road access makes downtown Kalisof just 40 minutes away. Did we mention the property is outside city limits? And that means less restrictions on building. Bring your family to a new home and enjoy the rest of your time here! Whether it's for a long-term stay or for your weekend getaways, this lot definitely delivers! Call now for the offer of a lifetime! Pricing Details: Cash: \$139,500 Property Details: Parcel Number: 7563-11-0446 County: Jackson State: NC Parcel Size: 0.62 acre City: CULLOWHEE Zip Code: 28723 Legal Description: LT 16 PH 2 SIGNAL RIDGE Center GPS Coordinates: 35.1392, -83.1455 Elevation: 3668 Ft Property Access: Dirt Terrain: Level
 ~~ Contact Norman Nelson to learn more: 56two-41two-2920 - normannelsoninvestments(at)gmail(do)com ~~

Contact

Email

Phone

sales@landcentury.com

888-526-3932